

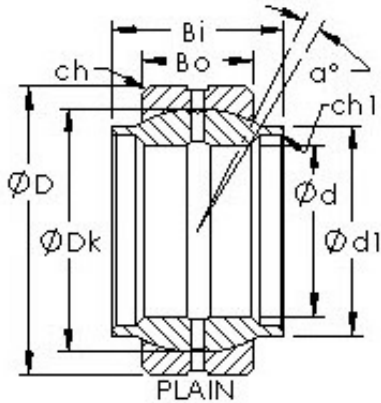

TRANSMISSIONS EUROPE CREZANCY



AST GEEW60ES plain bearings

Bearing No. GEEW60ES

Bore Diameter	60 mm
Outer Diameter	90 mm
Bearing Type	plain
Bore Dia (d)	60.0000
Outer Dia (D)	90.0000
Outer Width (Bo)	36.0000
Inner Width (Bi)	60.0000
Dynamic Load Rating (Cr)	245,000
Static Load Rating (Cor)	1,220,000
Max. shaft corner radius, or 45 deg. chamfer (ch1)	1.000
Max. housing corner radius, or 45 deg. chamfer (ch)	1.000
Spherical Diameter (dk or Dk)	80.000
Mis-alignment Angle (a deg.)	4
Extended Inner OD (d1)	68.000
Weight (g)	1,110.00
Material	52100 Chrome steel, or equivalent

GEEW60ES Bearing 2D drawings and 3D CAD models